

## **HOLIDAY ASSIGNMENT**

### **SS1 SCIENCE**

### **MATHEMATICS**

#### **QUESTION 1**

- a. The cost of making a dress is partly constant and partly varies with the amount of time it takes to make the dress. If the dress takes 3 hours to make, it costs N2,700. If it takes 5 hours to make the dress, it costs N3,100. Find the cost if it takes  $1\frac{1}{2}$  hours to make a dress.
- b. A cone has a radius of 10cm and a slant height of 26cm. Find the:
- total surface area, correct to 1 decimal place;
  - volume of the cone, correct to 2 decimal places;
  - angle of the sector that formed the cone, correct to the nearest degree.

#### **QUESTION 2**

- a. A quantity Y is directly proportional to X and inversely proportional to the square of Z. If  $Y = 6$  when  $X = 12$  and  $Z = 2$ .
- Express Y in terms of X and Z
  - Find the value of Y , when  $X = 5$  and  $Z = \frac{1}{3}$
  - Find the value of X when  $Y = 6$  and  $Z = \frac{2}{5}$

b. Solve the equation:  $\frac{2}{3}(3x - 5) - \frac{3}{5}(2x - 3) = 3$

## **ENGLISH LANGUAGE**

### **GRAMMAR**

The Bedrock of English Grammar for Senior Secondary Schools

Page 418 Exercise vii Questions i to x.

### **COMPREHENSION**

Pages 229 to 232

Question 2,3,4,6,7.

### **SUMMARY**

NCE, Page 229-230, Question 1.

### **SPEECH**

#### **Section A: Consonant Sounds /s/ and /z/ (5 Marks)**

Using a good English dictionary, check the transcriptions of the following words and arrange them according to their sound symbols in the table that follows

rise, ca <u>s</u> e, ha <u>s</u> , lo <u>o</u> se, ho <u>u</u> se (verb), lo <u>o</u> se, gl <u>a</u> ss, pa <u>s</u> s, phra <u>s</u> e, ho <u>u</u> se(noun).
--

/s/	/z/
1.	1.
2.	2.
3.	3.
4.	4.
5.	5.

### Section B: Monophthongs (5 Marks)

Write any **FIVE (5)** English monophthongs that you know and give one word, each, that represents the sounds in the Monophthongs you have listed.

### CIVIC-EDUCATION

- 1a. Define national value.
- b. There are several actions that can constitute justice or injustice, in view of this, explain any **FOUR (4)** types of Justice.
- c. What do you understand by community service?
- 2a. Define Nationalism.
- b. Mention any **FOUR (4)** Nigerian nationalists you know.
- c. Highlight any **TWO (2)** roles played by nationalists in Nigeria.

## **ECONOMICS**

- 1a. Explain the term 'migration.'
  - b. State any **FOUR (4)** features of a good population census.
  - c. Define the term 'Debt Rate.'
- 
- 2a. Mention **THREE (3)** factors affecting birth rate.
  - b. State Malthusian theory of population.

## **BIOLOGY**

1. Define micro organisms.
2. Name **THREE (3)** groups of micro organisms and give one example of each.
3. State **FOUR (4)** ways of controlling micro organisms.
- 4.. State **THREE (3)** harmful effects of micro organisms to humans.

## **COMPUTER STUDIES**

- 1a. What is Data network?
- b. Enumerate the types of Data networks.
- c. State the full meaning of SIM.

- 2a. What do you understand by telecommuting?
- b. Write short notes on the following Microsoft word features:
  - a. Print preview
  - b. Indentation
- c. Define the term word processor and Highlight **THREE (3)** examples of word processors.

### **ANIMAL HUSBANDRY**

- 1a. Differentiate between Endoparasite and Ectoparasite.
- b. Highlight **TWO (2)** advantages of intensive systems of livestock management.
- c. What is culling?
- 2a. Define Livestock management.
- b. State **TWO (2)** factors influencing livestock management.
- c. Mention **TWO (2)** importance of horn in farm animals.

### **MARKETING**

- 1a. Explain marketing research.
- b. There are several reasons for carrying out marketing research. Highlight **FOUR (4)** of these reasons.
- 2a. Define the terms below:
  - i. Pricing;
  - ii. Price.

- b. Mention **FOUR (4)** determinants of pricing.

## **DATA PROCESSING**

- 1a. What is word processing?
  - b. Write short notes on the following Microsoft word features:
    - a. Spell checker
    - b. Insert text
    - c. Header
  - c. State **TWO (2)** precautions while doing practical in computer lab.
- 
- 2a. Write short notes on the following as related to Microsoft Excel.
    - a. Wrap text
    - b. Alignment
    - c. Concatenation
  - b. Mention **FOUR (4)** file extension formats that a database document can be saved as.
  - c. Enumerate **TWO (2)** examples of spreadsheet package.

## **DYEING AND BLEACHING**

- 1a. Outline **TEN (10)** steps to follow in batik production using **TWO (2)** colours.
  - b. State **FIVE (5)** ways tie dye waste can be properly disposed to prevent environmental pollution.
  - c. Highlight **THREE (3)** problems that can occur during dyeing process.
- 
- 2a. Explain the term marbling by tying.
  - b. List **THREE (3)** places dyeing of a fabric can take place.
  - c. Define the term bleaching in tie dye .

## **FURNITURE MAKING**

### **PART A: THEORY**

- 1a. Make a neat pictorial sketch of any wood work holding device.
  - b. State **ONE (1)** use of each of the following workshop tools:
    - i. Cross cut saw
    - ii. Jointer
  - c. What is kickback in machine operations?
- 
- 2a. Mention **TWO (2)** examples of workbench fittings.
  - b. List **FOUR (4)** first aid materials you know.
  - c. Outline **TWO (2)** parts of a drill press.

## PART B: DRAWING AND DESIGN

3. Make a neat freehand sketch of a check defect in timber.
4. Draw and label the cross section of a timber.

## FURTHER MATHEMATICS

- 1a. SOLVE  $3^{2x} - 30(3^x) + 81 = 0$
- b. The sum of the first two terms of an exponential sequence is 135 and the sum of the third and the fourth terms is 60. Given that the common ratio is positive, calculate;
  - i. the common ratio and the first term.
  - ii. the least number of terms for which the sum exceeds 240.
2. Two functions  $f(x)$  and  $g(x)$  are defined on the set of real numbers by
$$f(x) = 3x^2 - 2 \text{ and } g(x) = x + 3.$$
 Find
  - a  $f(-2)$
  - b  $g^{-1}(-2)$
  - c The value of  $x$  for which  $f[g(x)] = g[f(x)]$
  - d  $f^{-1}[g(4)]$



## PHYSICS

- 1a. State Hooke's law of elasticity.
- b. Derive the equation for young modulus.
- c. Find the effective resistance of two 3ohms resistors in a parallel arrangement.
- 2a. Show that  $E = I(R + r)$ .
- b. Differentiates between solid friction and viscosity.
- c. Explain surface tension.
- ii. Give **TWO (2)** factors that affect the surface tension of a liquid.

## CHEMISTRY

- 1a. Write a balanced equation for the complete combustion of carbon.
- b. State **ONE (1)** physical property of the product formed.
- c. Differentiate between an alkali and a base.
- 2a. State the modern periodic law.
- b. State **TWO (2)** ways in which soluble salts can be prepared.
- c. Give **ONE (1)** example of a base.

## **GEOGRAPHY**

- 1a. Transportation plays a vital role in the economic development of a Nation.  
Discuss.
  - b. Highlight **FIVE (5)** problems of transportation in Nigeria.
  - c. In what **THREE (3)** ways can government proffer solutions to these problems?
- 
- 2a. What is an Industry?
  - b. Discuss any **FIVE (5)** factors affecting location of Industry in Nigeria.
  - c. Explain **THREE (3)** problems of industrial location.

## **AGRICULTURAL SCIENCE**

- 1a. Define Pasture.
  - b. State **FOUR (4)** management practices in pasture.
- 
- 2a. What is farm mechanization?
  - b. Highlight **FIVE (5)** ways of maintaining simple farm tools.

## TECHNICAL DRAWING

**Question 1:** Reproduce **Fig. Q1** below using the principle of tangency.

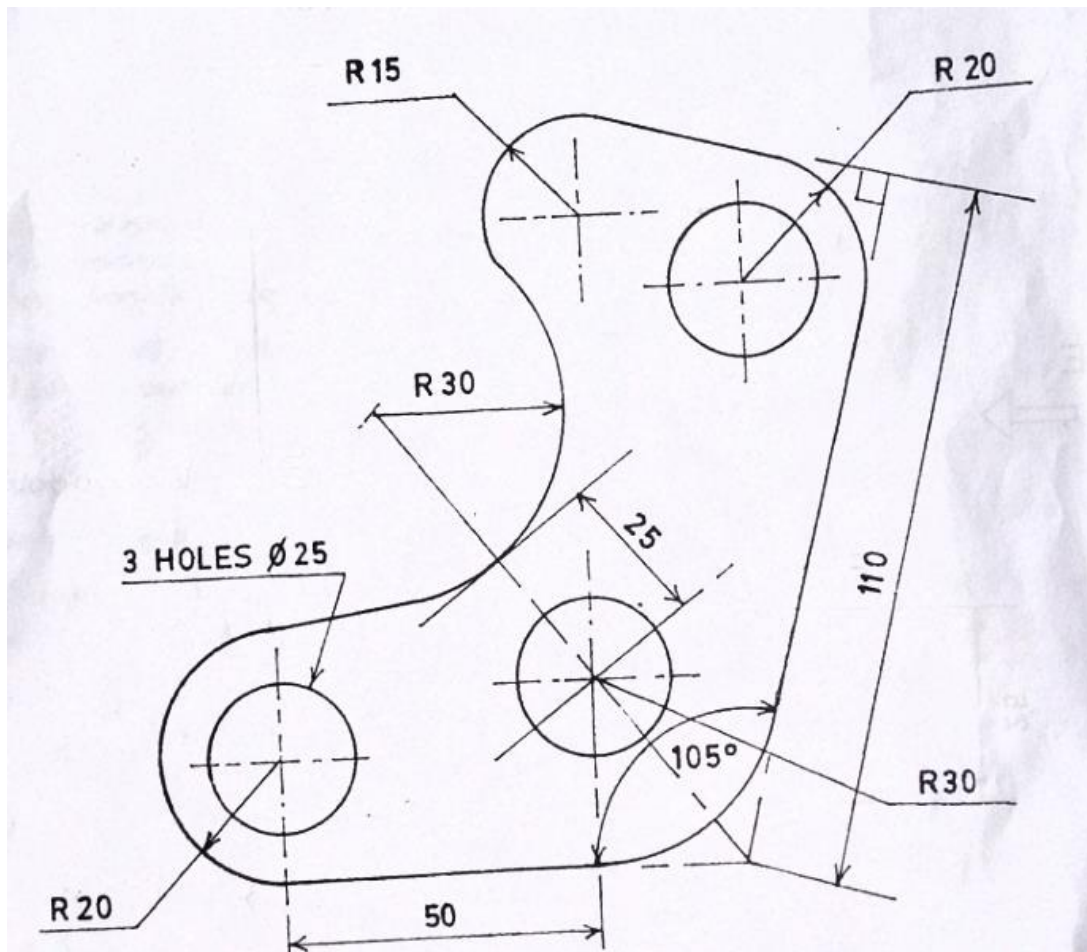

**Fig. Q1**

**Question 2:** Identify the type of pictorial drawing in **Fig. Q2** below and neatly reproduce it.

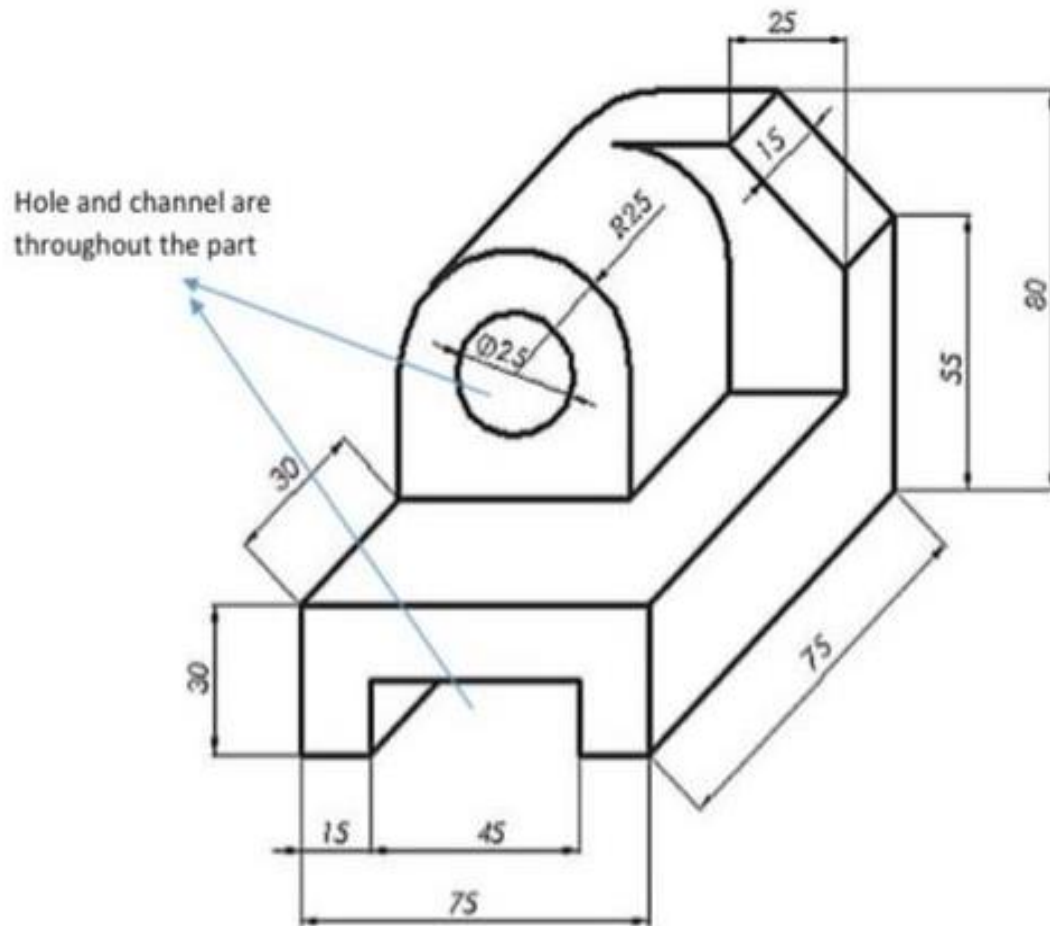

**Fig. Q2**

## **FRENCH LANGUAGE**

- 1a. Formation du futur simple.
- b. Mentionnez 1 verbe terminé par : er, ir, ire, dre, oir.
- c. Conjuguez chacun des verbes cités au futur simple.
  
- 2a. Formation du passé composé.
- b. Mentionnez 3 verbes utilisant 'avoir' et 2 verbes utilisant 'être' au passé composé.
- c. Conjuguez tous les 5 verbes au passé composé.

## **YORUBA LANGUAGE**

- 1a. Ninu iwe Eegun Alare, se afiwe iwa Iyadunni pelu ti Anseetu ninu ijora ti o dara.
- b. Amunmora wo ni Anseetu ni ti ko si fun Iyadunni?
- d. Iru eda wo ni Dasofunjo,ni soki se alaye.
  
- 2a. Iyato wo lo wa laarin Ojelarinnaka ati Dadofunjo?
- b. Tani o koko tawo ogun si enikan laarin Ojelarinnaka ati Duduyemi?
- d. Tani o gba oye baale Areku,se alaye ni soki.